

YUKON ADVENTURE RACK KIT



P/N 2882084

APPLICATION

Verify accessory fitment at Polaris.com.

BEFORE YOU BEGIN

Read these instructions and check to be sure all parts and tools are accounted for. Please retain these installation instructions for future reference and parts ordering information.

KIT CONTENTS

This Kit includes:

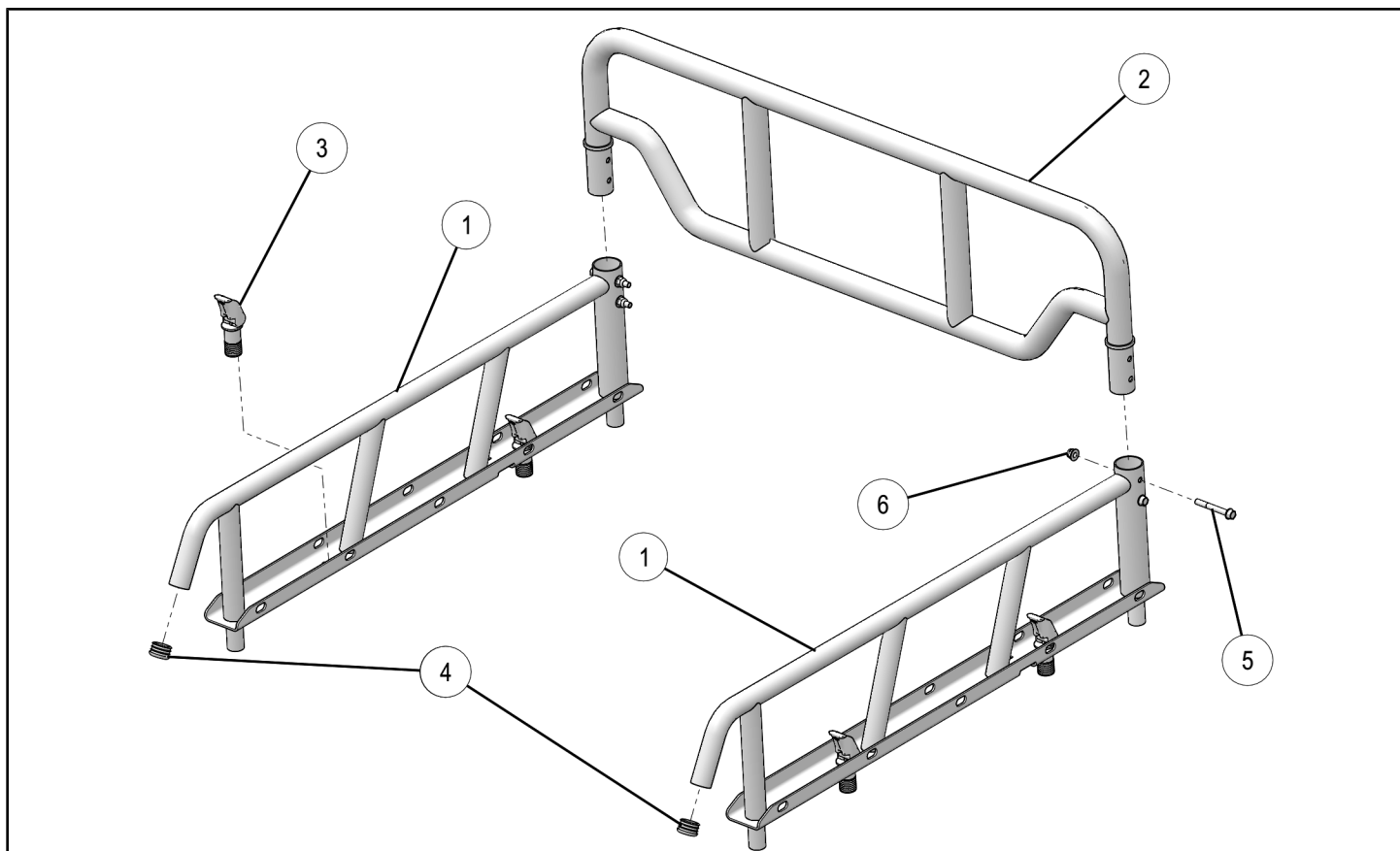

REF	QTY	PART DESCRIPTION	PART NUMBER
1	2	Side Rail	1022586
2	1	Front Rail	1022587
3	4	Anchor Kit, LOCK & RIDE®	2881308
4	2	Cap, Plug End	2002084
5*	4	Bolt - M8 X 1.25 X 65	-
6*	4	Nut - M8 X 1.25	-
	1	Instructions	9927258

Items marked (*) are included in Hardware Kit PN 2206394.

TOOLS REQUIRED

- Safety Glasses
- Metric Wrench Set

- Metric Socket Set

IMPORTANT

Your YUKON ADVENTURE RACK KIT is exclusively designed for your vehicle. Please read the installation instructions thoroughly before beginning. Installation is easier if the vehicle is clean and free of debris. For your safety, and to ensure a satisfactory installation, perform all installation steps correctly in the sequence shown.

ASSEMBLY TIME

Approximately 15 minutes

INSTALLATION INSTRUCTIONS

1. Place vehicle in "PARK". Turn key to "OFF" position and remove from vehicle.
2. Assemble two LOCK & RIDE® expansion anchors ③ onto side rails ① as shown.

NOTE

Refer to instructions (PN 9926321) included with LOCK & RIDE® expansion anchor kit.

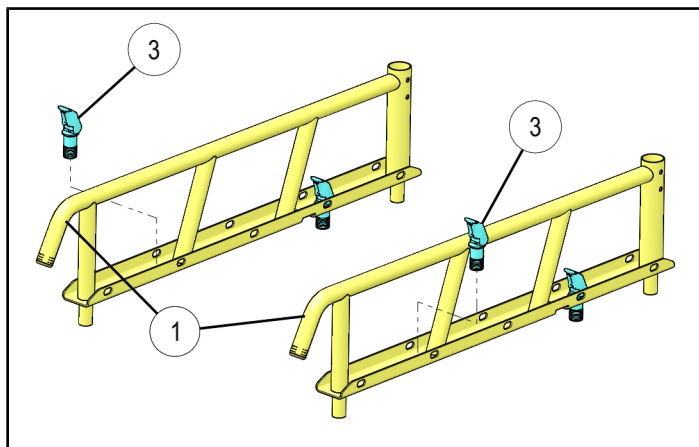

3. Align side rail ① and LOCK & RIDE® expansion anchors ③ with bed holes and insert into vehicle as shown. Press down on LOCK & RIDE® anchors to fully seat in the holes on the vehicle.

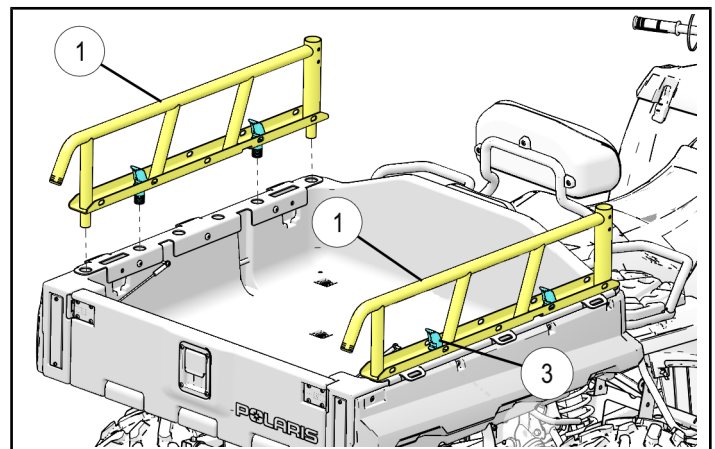

4. Rotate LOCK & RIDE® upper cams ③ as shown to lock in place. If installation is loose, unlatch cam, rotate clockwise to tighten, and re-latch.

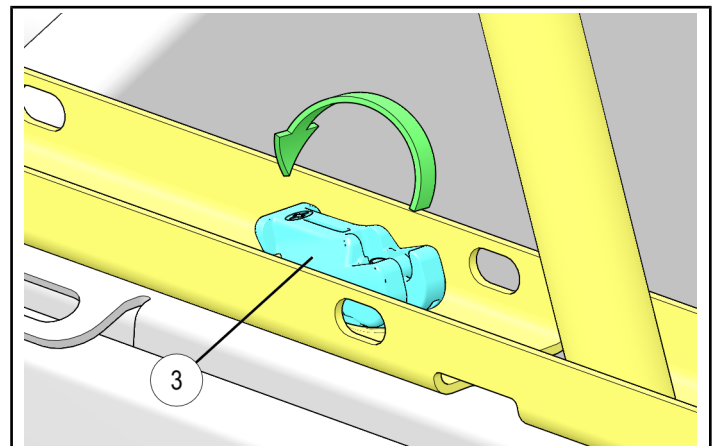

5. Insert front rail ② onto side rails ① as shown. Install front rail ② using two screws ⑤ and nuts ⑥ on each side. Torque to specification.

TORQUE

16 ft. lbs. (21.6 Nm)

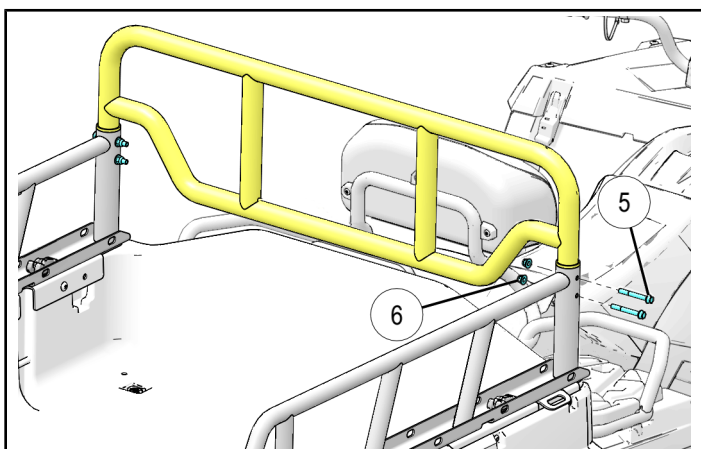
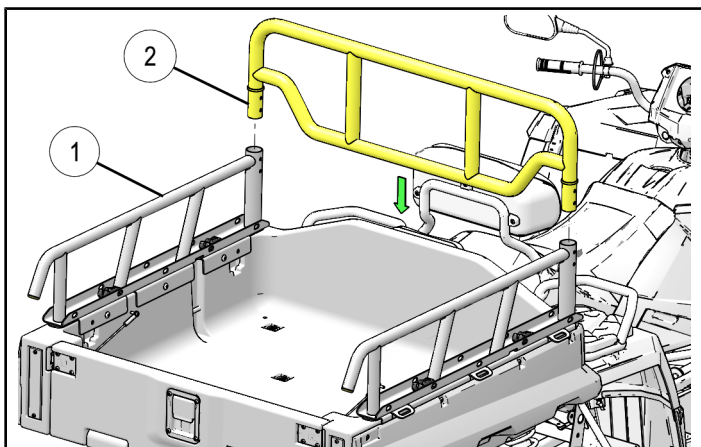

6. Final kit installation is shown below.

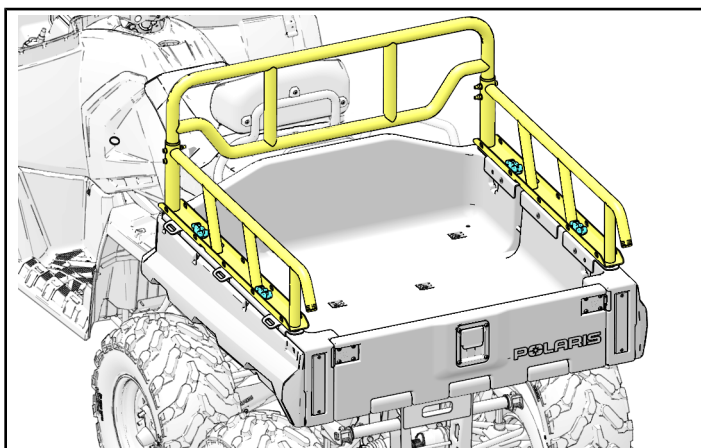

7. Yukon adventure rack kit can be removed by unlocking the LOCK & RIDE® expansion anchors ③. Lift rack kit assembly away from the vehicle bed as shown.

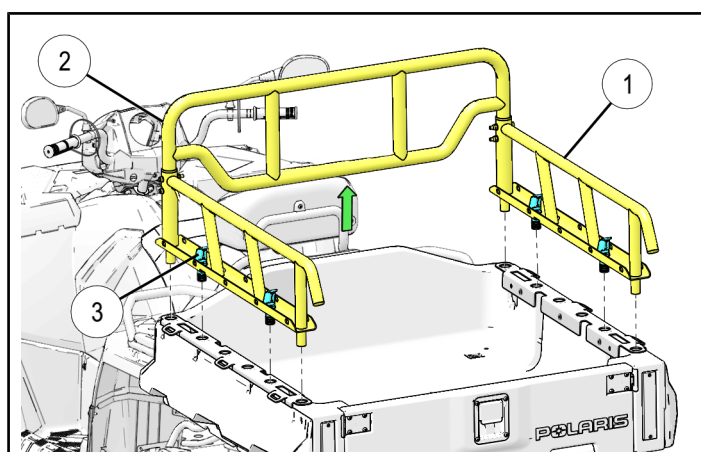
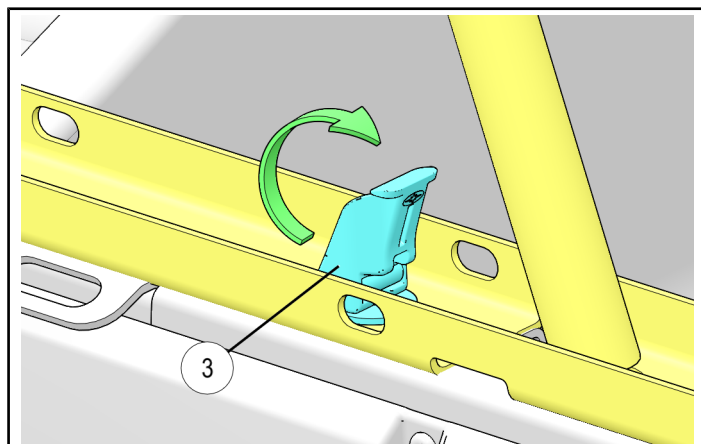

COMPATIBILITY

Yukon adventure rack kit is compatible with following accessory kits.

- Storage Box Mounting Kit (PN 2882302) and Cargo Box Kit (PN 2875176).
- Gun Mount Adapter Kit (PN 2882257) with Gun Scabbard Mount Kit (PN 2879888).