

WINDSHIELD KIT



P/N 2883586; 2883587; 2884946; 2890616; 2890617; 2890618

MISSING OR DAMAGED PARTS

Before beginning assembly, inspect the kit and its component(s) to be sure all parts and tools are accounted for and not damaged. If missing parts or parts are damaged, please contact your Selling Dealer for assistance.

If your accessory was purchased online, please contact POLARIS® customer service at **1-800-POLARIS** (US & Canada only).

APPLICATION

Verify accessory fitment at www.polaris.com.

KIT CONTENTS

P/N 2883586; 2883587; 2884946

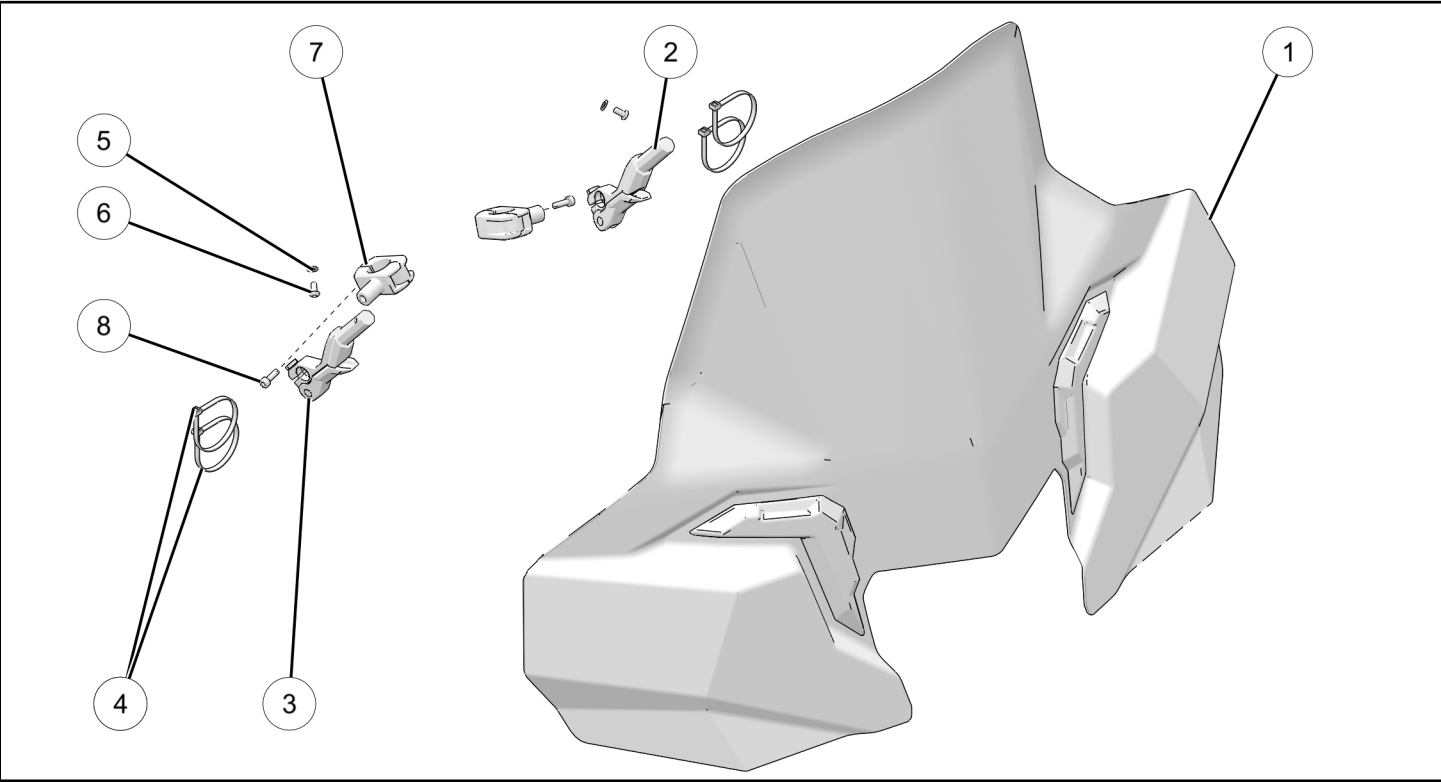

NOTICE				
Kit 2884945 shown, other kits similar				

REF	QTY	PART DESCRIPTION	P/N AVAILABLE SEPARATELY	AVAILABLE SERVICE KIT
1	1	Windshield	n/a	n/a
2	1	Left Windshield Mounting Arm	n/a	2889197
3	1	Right Windshield Mounting Arm	n/a	2889197
4	4	Cable Tie	7080492	2208774
5	2	Washer	n/a	2889197

REF	QTY	PART DESCRIPTION	P/N AVAILABLE SEPARATELY	AVAILABLE SERVICE KIT
6	2	Screw	n/a	2889197
7	2	Windshield Mount Clamp	n/a	2889197
8	2	Screw	n/a	2889197

P/N 2890616; 2890617; 2890618

REF	QTY	PART DESCRIPTION	P/N AVAILABLE SEPARATELY	AVAILABLE SERVICE KIT
1	1	Windshield	n/a	n/a
2	1	Left Windshield Mounting Arm	n/a	2890615
3	1	Right Windshield Mounting Arm	n/a	2890615
4	4	Cable Tie	7080492	2208774
5	2	Washer	n/a	2890615
6	2	Screw	n/a	2890615
7	2	Windshield Mount Clamp	n/a	2890615
8	2	Screw	n/a	2890615

TOOLS REQUIRED

- Safety Glasses
- Hex Key Set, Metric
- Pliers, Side Cutting
- Socket Set, Hex Bit, Metric
- Socket Set, Torx® Bit
- Torque Wrench

IMPORTANT

Your Windshield Kit is exclusively designed for your vehicle. Please read the installation instructions thoroughly before beginning. Installation is easier if the vehicle is clean and free of debris. For your safety, and to ensure a satisfactory installation, perform all installation steps correctly in the sequence shown.

INSTALLATION INSTRUCTIONS

VEHICLE PREPARATION

GENERAL

1. Park vehicle on a flat surface.
2. Push engine stop switch to the OFF position.
3. Turn key to the OFF position and remove key.

4. Loosen master cylinder fasteners (A).

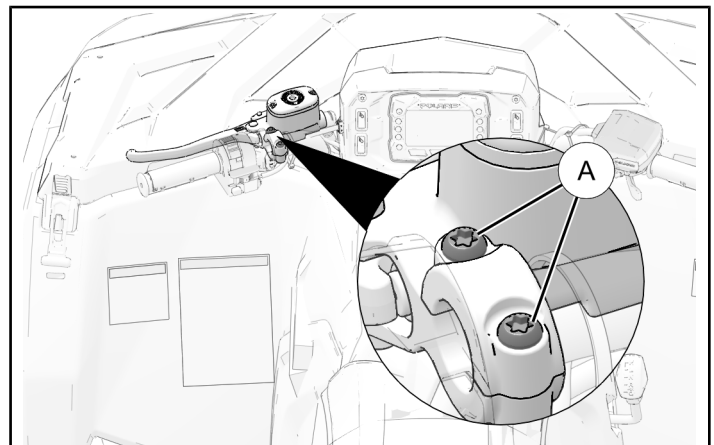

- Remove cable ties ⑧.

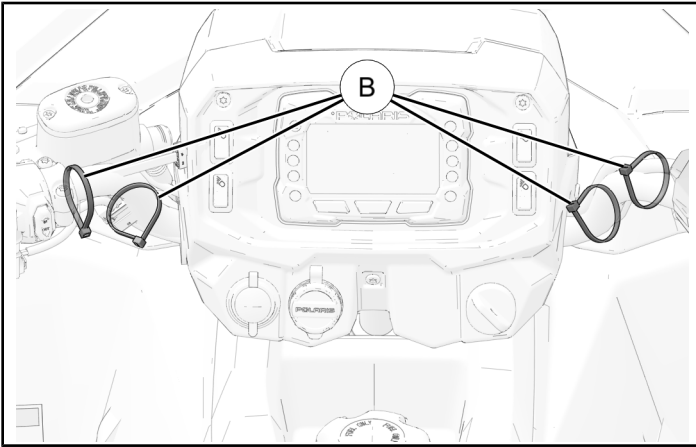

ACCESSORY INSTALLATION

- Install the left ② and right ③ windshield mounting arms on windshield ①.

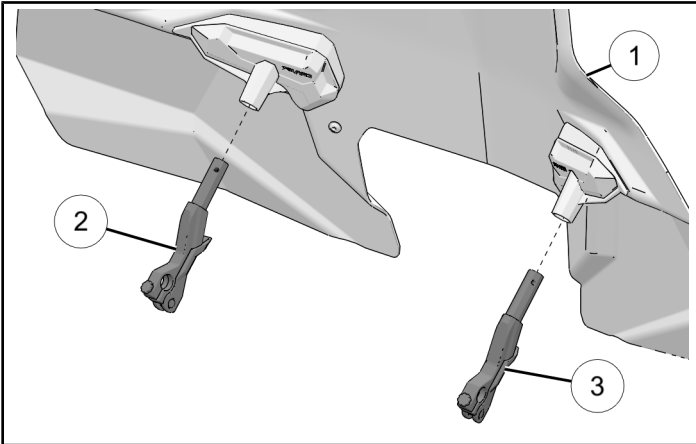

- Attach mounting arms using washer ⑤ and screw ⑥.

DO NOT torque fasteners at this time.

NOTICE

Left side shown; right side similar.

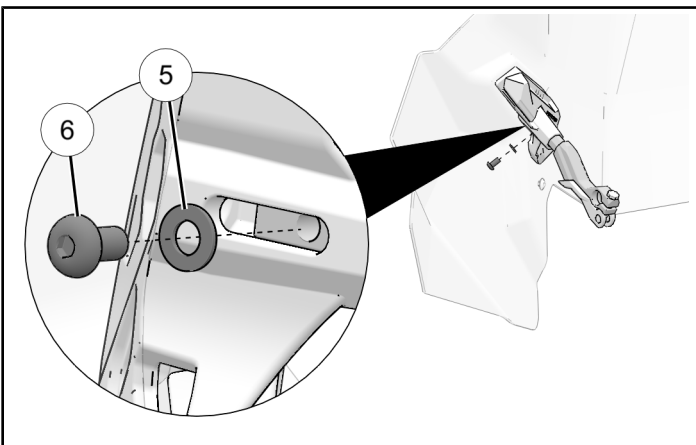

- Loosely install windshield mounting clamps ⑦ using fasteners ⑧.

DO NOT torque fasteners at this time.

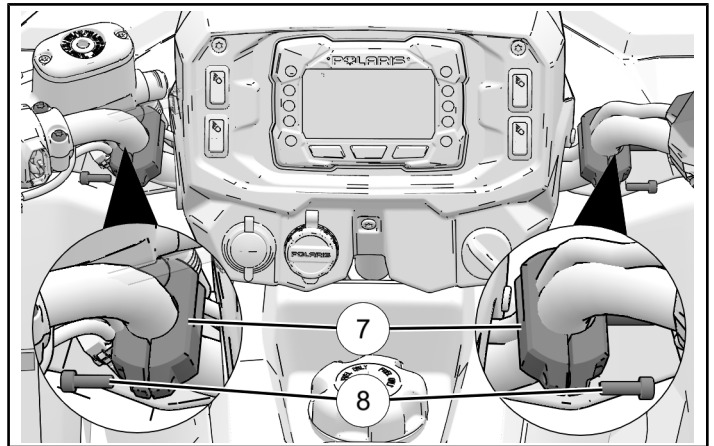

- Install the windshield assembly onto the mounting clamps. Torque the mounting arm fasteners ⑥ and mounting clamp fasteners ⑧ to specification.

TORQUE

Windshield Mount Fasteners ⑥ ⑧:
16 in-lbs (1.8 N·m)

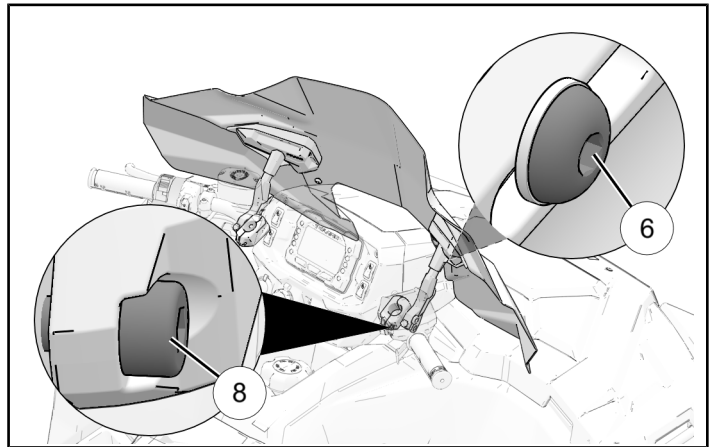

- Attach wiring using cable ties ④.

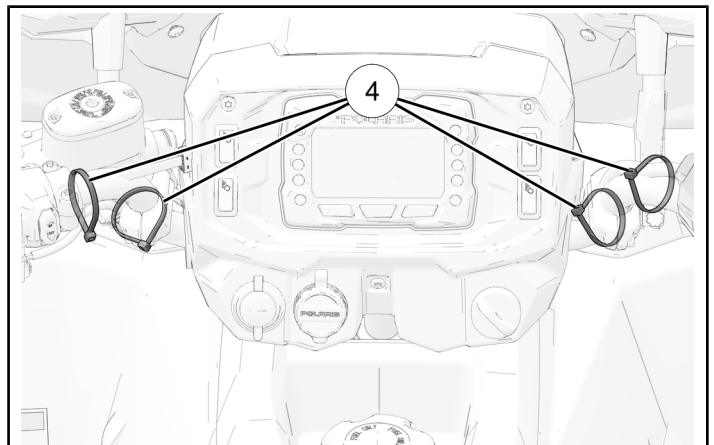

WINDSHIELD ADJUSTMENT

1. Turn adjustment knob counter-clockwise to loosen clamp and adjust windshield mount. Turn knob clockwise to tighten.

NOTICE

Right side shown; left side similar.

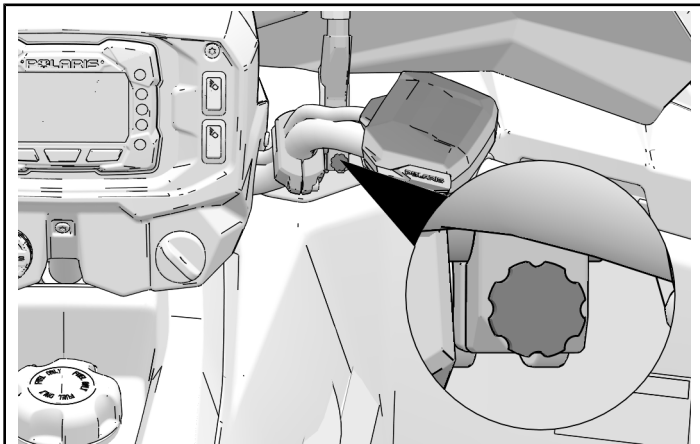

2. Remove mount covers and loosen fasteners on the inside of the windshield to adjust windshield position. Adjust as needed and torque fasteners to specification. Reinstall the mount covers.

NOTICE

Right side shown; left side similar.

TORQUE

Windshield Mount Fasteners:
16 in-lbs (1.8 N·m)

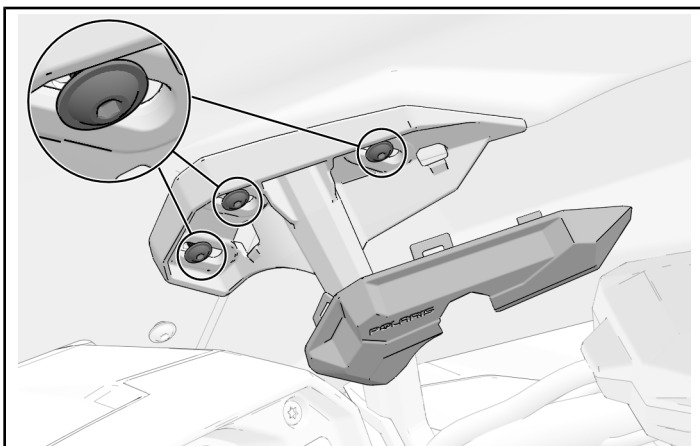

VEHICLE REASSEMBLY

GENERAL

1. Adjust master cylinder. Torque master cylinder mounting fasteners **A** to specification.

TORQUE

Master Cylinder Mounting Fasteners:
84 in-lbs (9 N·m)

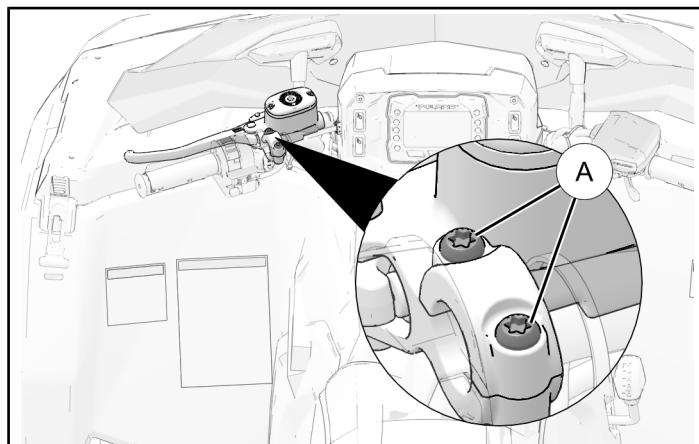

CARE AND CLEANING

Clean windshield with warm water and mild soap. Dry with a soft clean cloth.

NOTICE

Do not use glass cleaners, water or soil repellents, petroleum or alcohol based cleaners on the windshield. Chemical cleaners will permanently damage windshield.