

ROOF LINER KIT



P/N 2882912; 2882913; 2882914; 2884416; 2890526; 2890684

MISSING OR DAMAGED PARTS

Before beginning assembly, inspect the kit and its component(s) to be sure all parts and tools are accounted for and not damaged. If missing parts or parts are damaged, please contact your Selling Dealer for assistance.

If your accessory was purchased online, please contact POLARIS® customer service at **1-800-POLARIS** (US & Canada only).

APPLICATION

Verify accessory fitment at [Polaris.com](https://polaris.com).

REQUIRED SOLD SEPARATELY

Only parts for installation of the Roof Liner Kit are included. Prior installation of the following additional kit is also required (sold separately):

- Poly Roof Kit, P/N 2882911

KIT CONTENTS

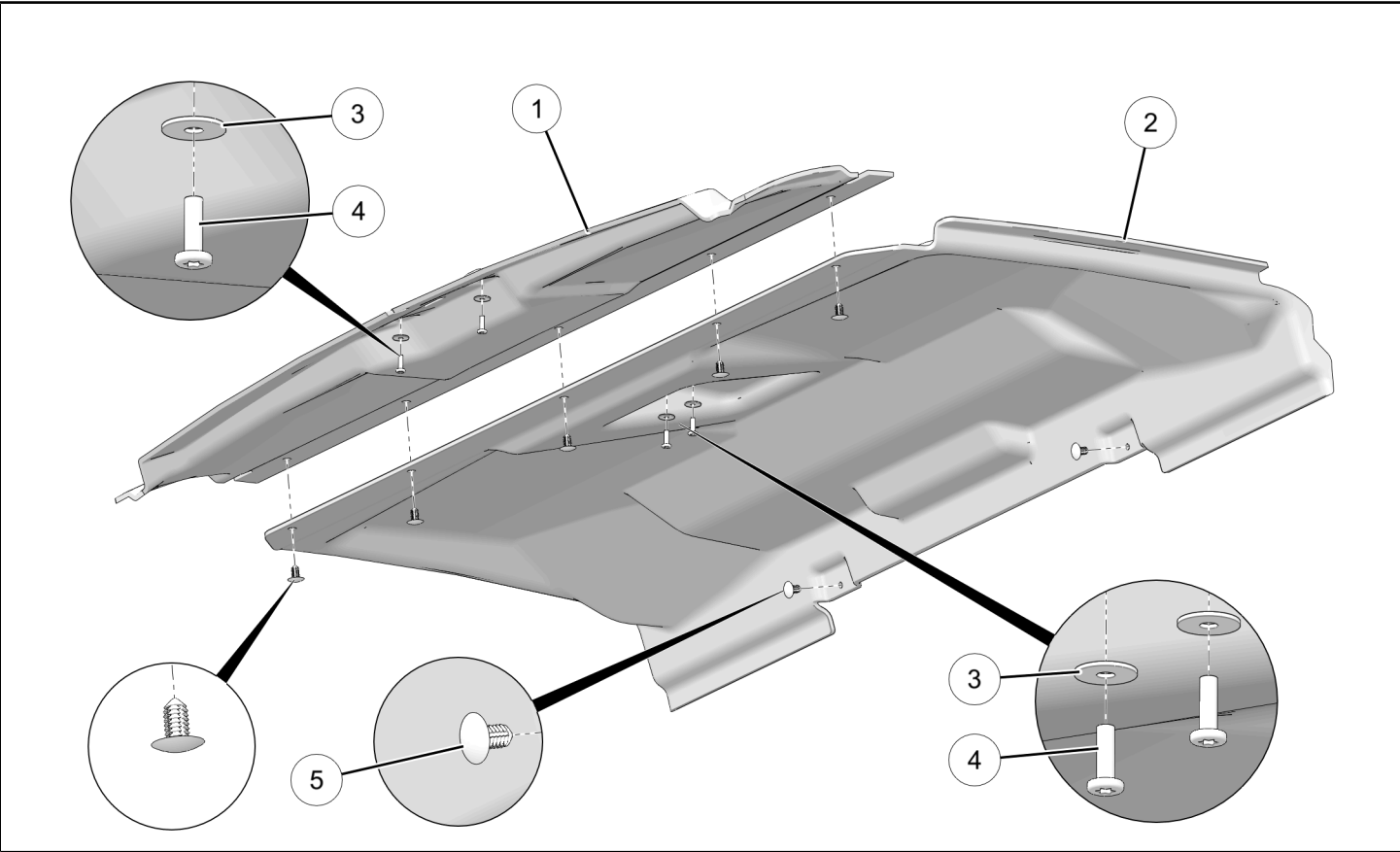

REF	QTY	PART DESCRIPTION	PART NUMBER
1	1	Liner, Front	5814646
2	1	Liner, Rear	5814714
3	4	Washer, 0.2 x 0.67 x 0.048 mm	7556034

REF	QTY	PART DESCRIPTION	PART NUMBER
4	4	Screw, Torx® Pan Head, High/Low - #10 X 5/8	7518238
5	7	Push Dart	7670088
6	1	Decal, "Be Prepared/Drive Responsibly" (Kit P/N 2882914 only) (not shown)	7187261
7	1	Decal, "Require Proper Use/Do Your Part" (Kit P/N 2882914 only) (not shown)	7187260
8	1	Decal, "Payload" (Kit P/N 2882914 only) (not shown)	7187264
9	1	Decal, "Never Operate/Always" (Kit P/N 2884416 only) (not shown)	7300076
10	1	Decal, "Require Proper Use/Do Your Part" (Kit P/N 2884416 only) (not shown)	7300098

TOOLS REQUIRED

- Safety Glasses
- Cutting Tool*
- Screwdriver Set, Torx®

* Tool requirement dependent on specific installation.

IMPORTANT

Your Roof Liner Kit is exclusively designed for your vehicle. Please read the installation instructions thoroughly before beginning. Installation is easier if the vehicle is clean and free of debris. For your safety, and to ensure a satisfactory installation, perform all installation steps correctly in the sequence shown.

VEHICLE PREPARATION

GENERAL

1. Park vehicle on a flat surface.
2. Shift vehicle into PARK.
3. Turn key to OFF position and remove key.

ACCESSORY INSTALLATION

1. OPTIONAL: If installing one or both of the following accessories (sold separately), then modify rear liner ② as described below.
 - Light: Cut oval opening ① or rectangular opening ②, as required, to accommodate light. Install electrical harness per instructions included with accessory.
 - Rear Speakers: Cut two circular openings ③ or, if equipped with JBL® speakers, two star-shaped openings ④ and open associated fastener holes. Install electrical harness per instructions included with accessory.

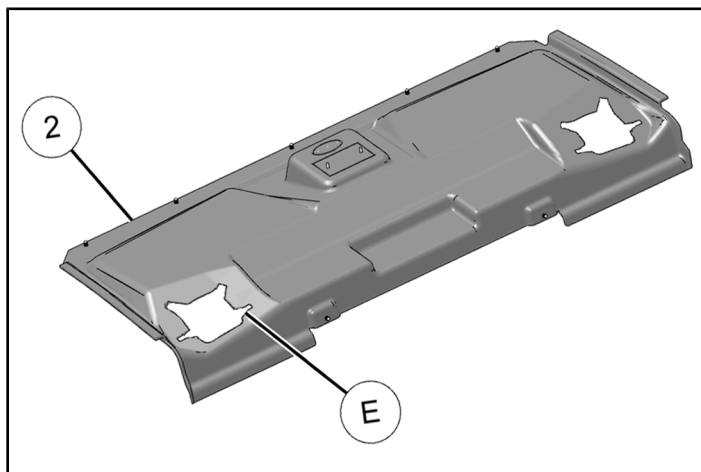
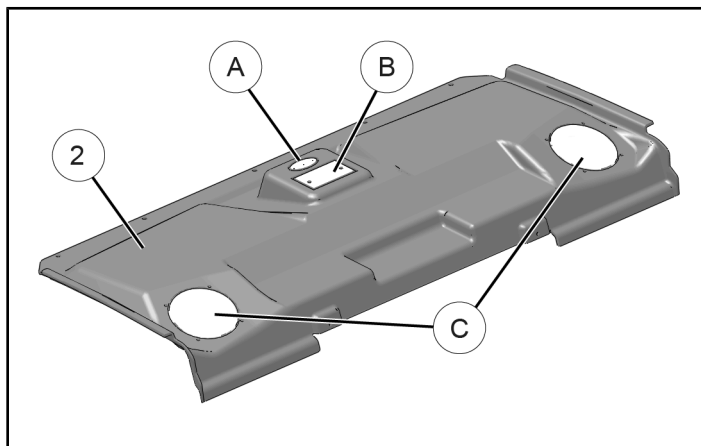

2. Install front liner ① to roof panel using two each screws ④ and washers ③.

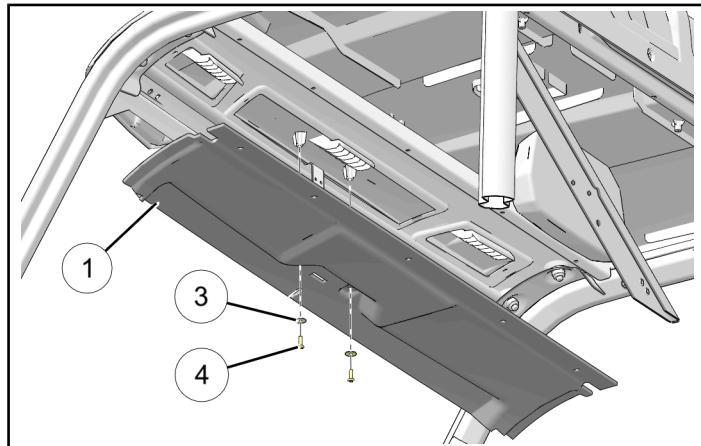

3. Insert both rear segments ① of rear liner ② into roof support channel, then slowly tip liner up, inserting left and right edges of liner between ROPS and roof seal.

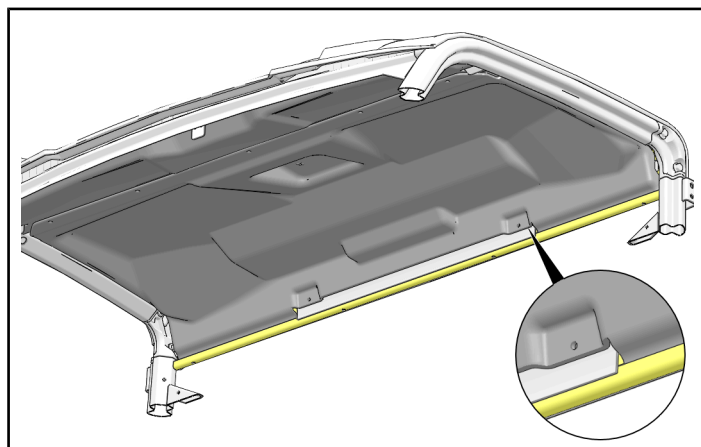
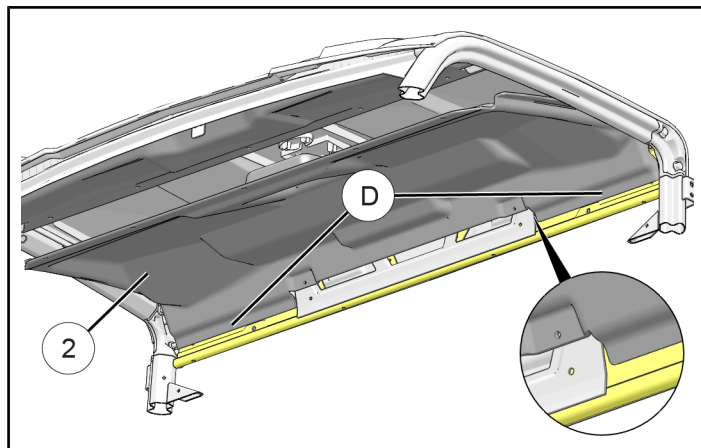

4. If installing optional light, then refer to instructions included with light. Otherwise, install two each screws ④ and washers ③ through rear liner ② into roof.

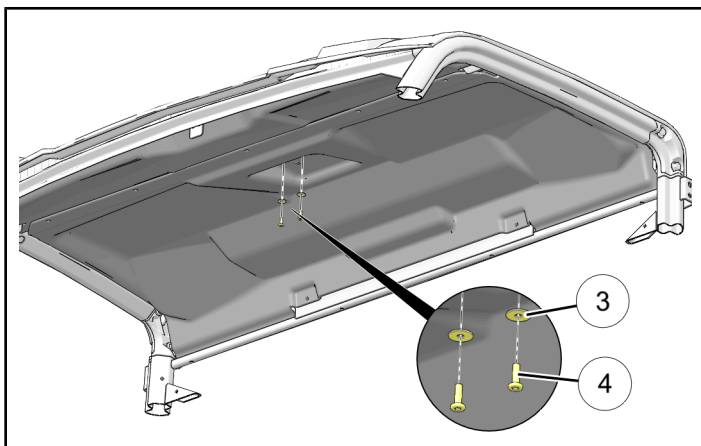

5. Secure rear liner ② by installing seven push darts ⑤, five into front edge and two into rear edge.

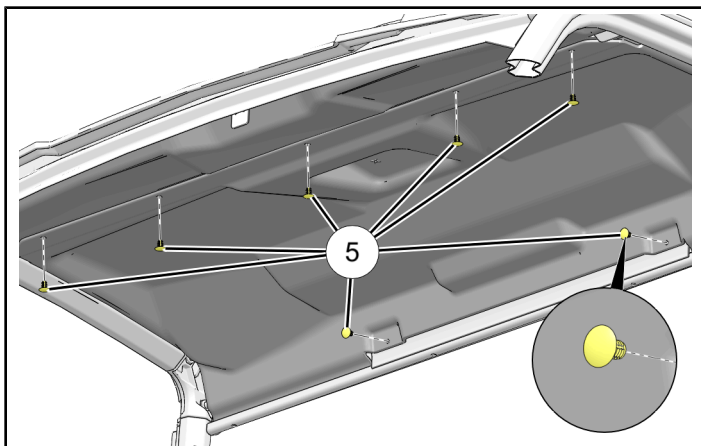

6. Decal application.

IMPORTANT

Decals required per ANSI/ROHVA standards.

MY18 and newer *RANGER XP*® 1000

Apply “Be Prepared/Drive Responsibly” decal ⑥, “Require Proper Use/Do Your Part” decal ⑦, and “Payload” decal ⑧ to front liner ① as shown.

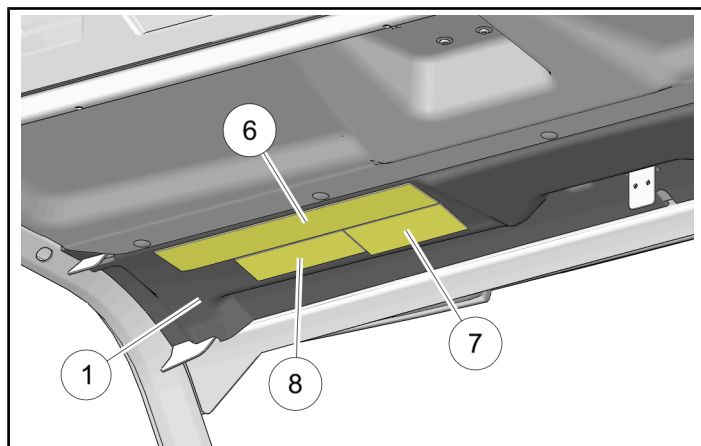

MY19 and older *RANGER XP*® 900

All required decals are applied to vehicle from factory. Decals ⑥, ⑦, and ⑧ are not used.

PRO XD™

Apply “Never Operate/Always” decal ⑨ and “Require Proper Use/Do Your Part” decal ⑩ to front liner ① as shown.

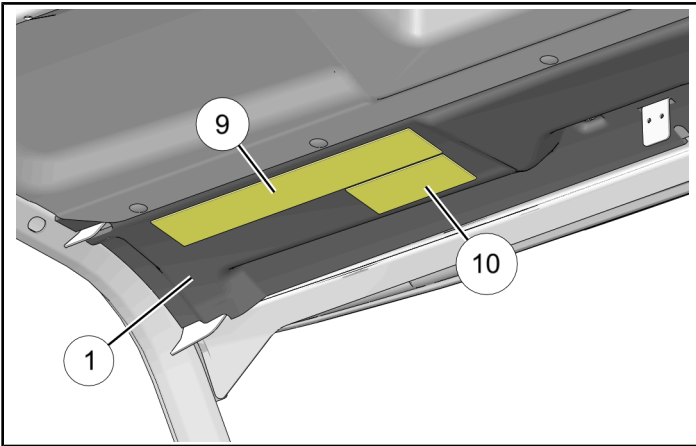

7. If installing optional rear speakers, then refer to instructions included with speakers.