

COBRA CORD KIT



P/N 2889918; 2889919; 2889920; 2889921; 2889922

BEFORE YOU BEGIN

Read these instructions and check to be sure all parts and tools are accounted for. Please retain these installation instructions for future reference and parts ordering information.

APPLICATION

Verify accessory fitment at www.polaris.com.

REQUIRED SOLD SEPARATELY

Only parts for installation of the Cobra Cord Kit are included. For complete installation, the following additional part is required (sold separately):

- V-Band Clamp, P/N 7082763

KIT CONTENTS



REF	QTY	PART DESCRIPTION	P/N AVAILABLE SEPARATELY
1	1	Cobra Cord	n/a

TOOLS REQUIRED

- Safety Glasses
- Exhaust Spring Tool
- Hex Key Set, Metric
- Screwdriver, Slotted

- Socket Set, Hex Bit, Metric

- Torque Wrench

CONSUMABLES REQUIRED

- Silicone Sealant

IMPORTANT

Your Cobra Cord Kit is exclusively designed for your vehicle. Please read the installation instructions thoroughly before beginning. Installation is easier if the vehicle is clean and free of debris. For your safety, and to ensure a satisfactory installation, perform all installation steps correctly in the sequence shown.

INSTALLATION INSTRUCTIONS

VEHICLE PREPARATION

GENERAL

1. Park vehicle on a flat surface.
2. Push engine stop switch to OFF position.
3. Turn key to OFF position and remove key.

REMOVE RIGHT SIDE PANEL

1. Turn three side panel latches toward rear of snowmobile to release, then remove side panel.

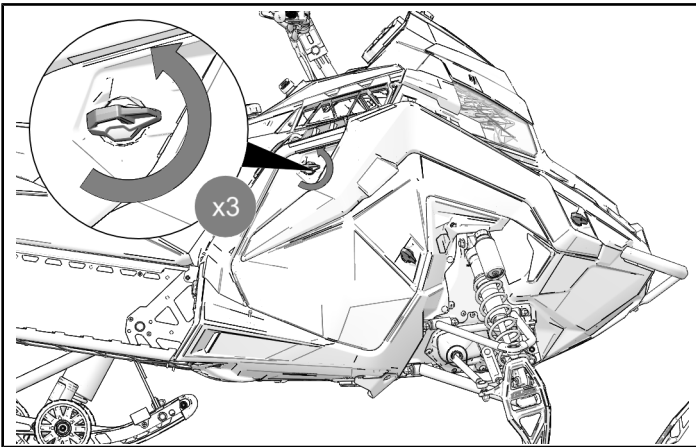

REMOVE EXHAUST SILENCER

1. Disconnect exhaust sensor.

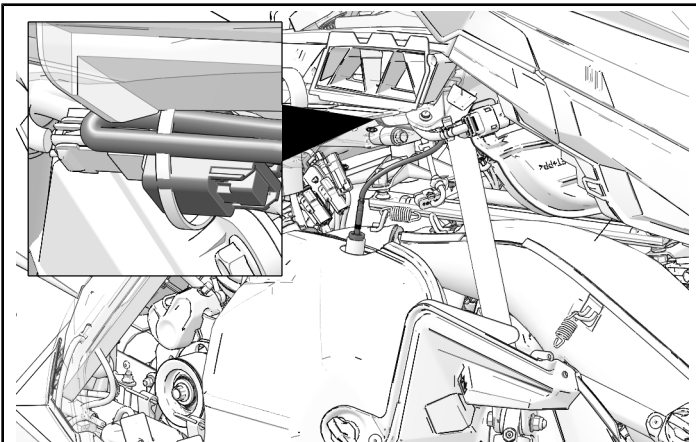

2. Remove four exhaust springs.

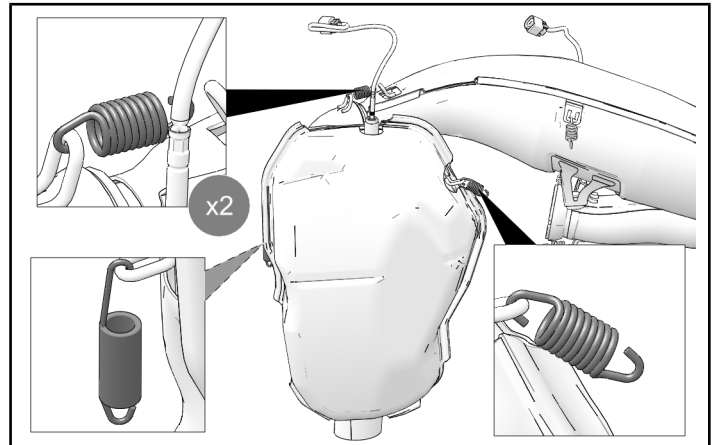
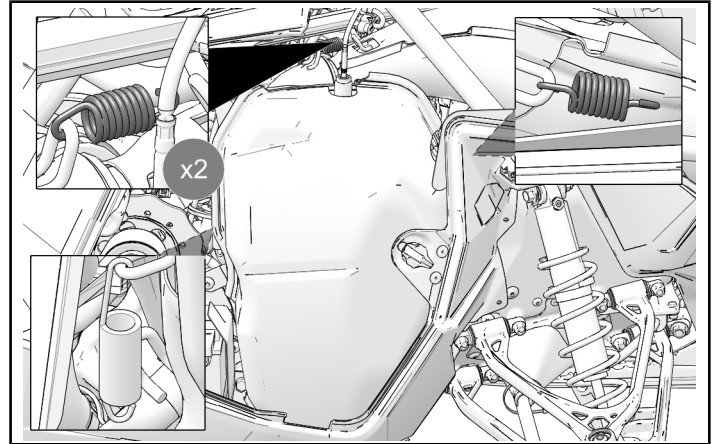

3. Remove silencer.

REMOVE BOOST EXHAUST SILENCER

IMPORTANT

Make sure to support turbo assembly when removing exhaust silencer.

1. Disconnect exhaust sensor.

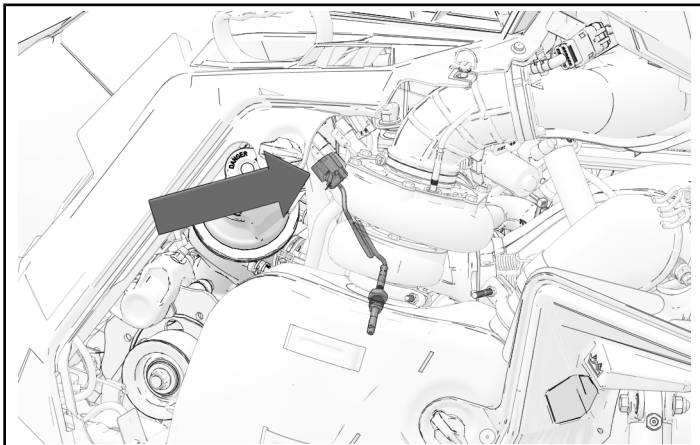

2. Remove v-band clamp.

NOTICE

Replace v-band clamp with new clamp, P/N 7082763

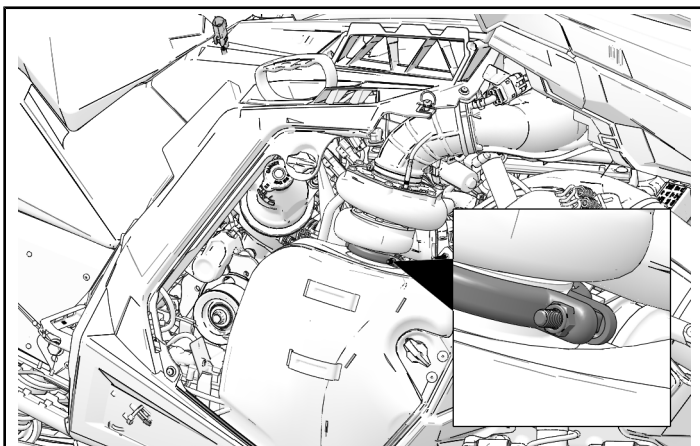

3. Remove two waste gate tube springs.

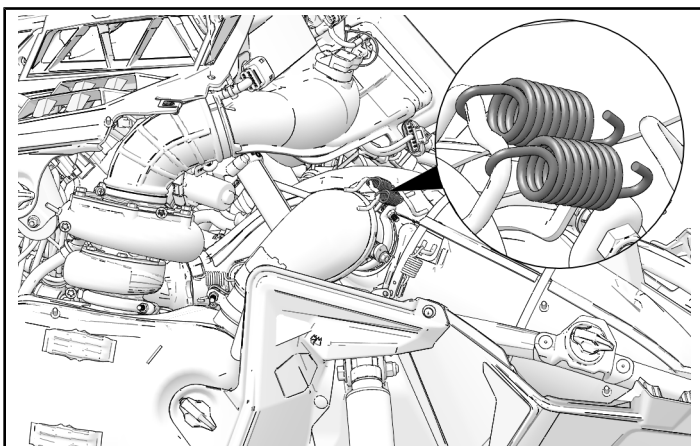

4. Remove exhaust spring.

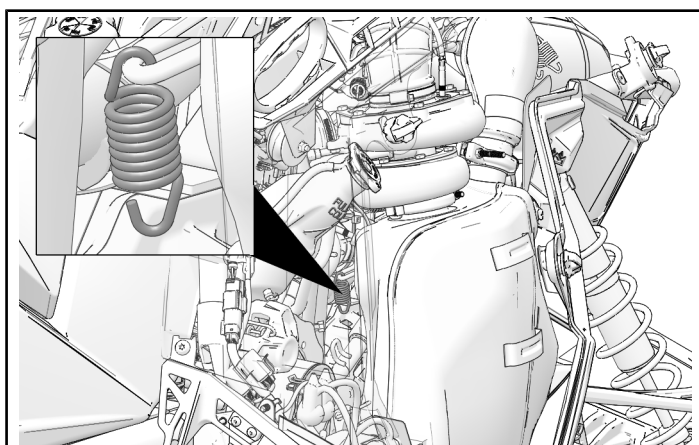

5. Remove silencer.

ACCESSORY INSTALLATION

1. Pull cord out of recoil and tie off so rope does not return inside recoil. Use an overhand loop knot.

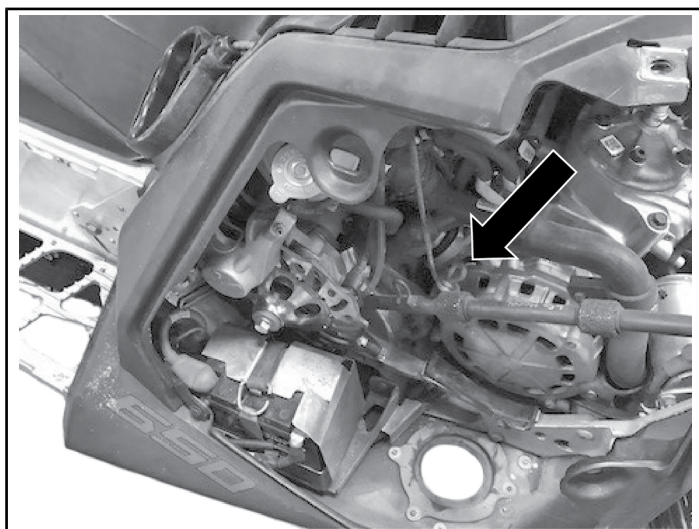
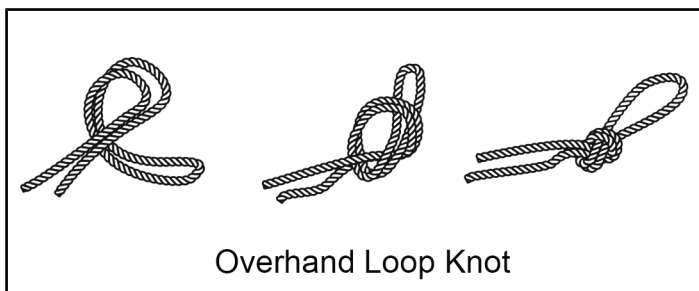

2. Pull back the rubber cover on the recoil handle.

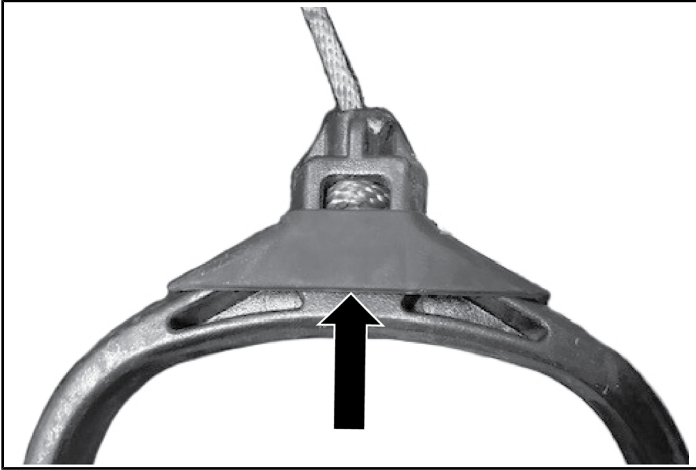

3. Pull rope through handle to expose knot. Untie knot or cut rope. Remove and keep recoil handle.

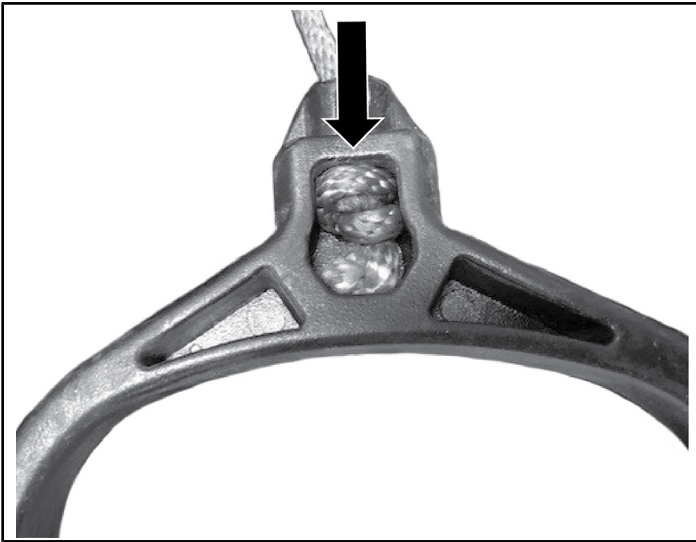

4. Remove seven recoil assembly fasteners. Remove recoil.

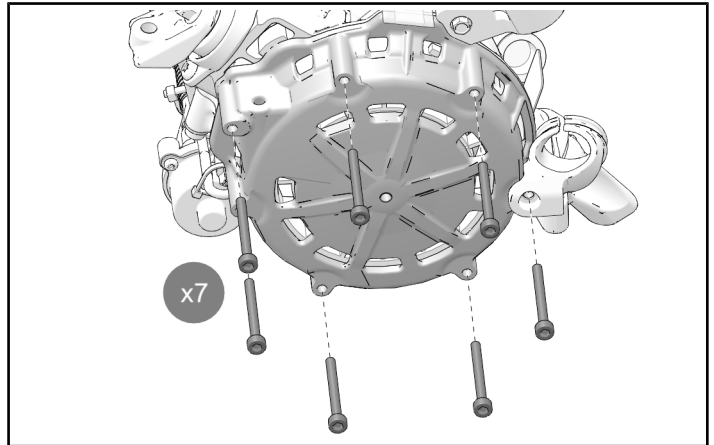
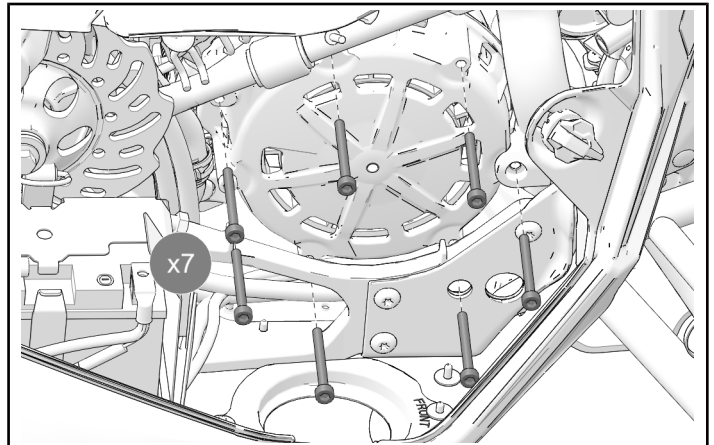

5. Pull recoil cord all the way out, then insert a screwdriver through openings in recoil assembly to hold recoil in place.



6. Remove silicone to expose knot in recoil cord. Cut knot from cord to remove cord.

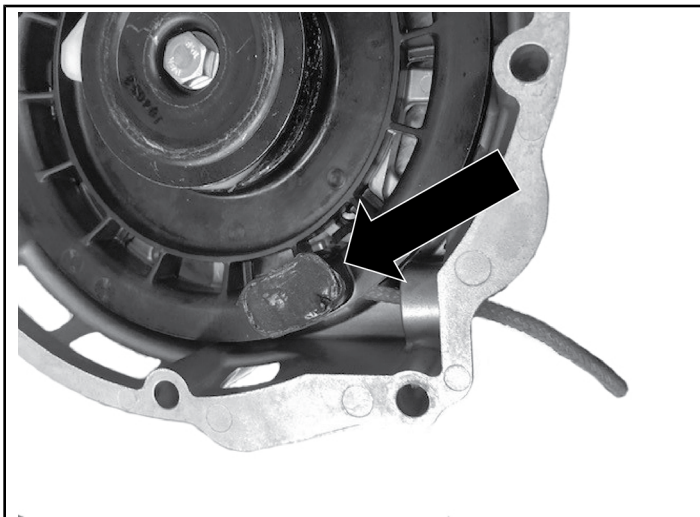

7. Install new recoil cord ① in recoil.

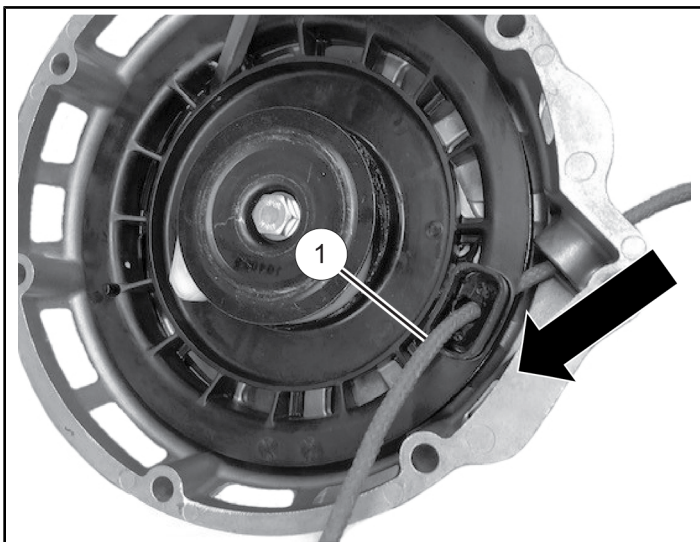

8. Tie a figure 8 knot in end of recoil cord. Push knot into recess. Trim end of cord if necessary.

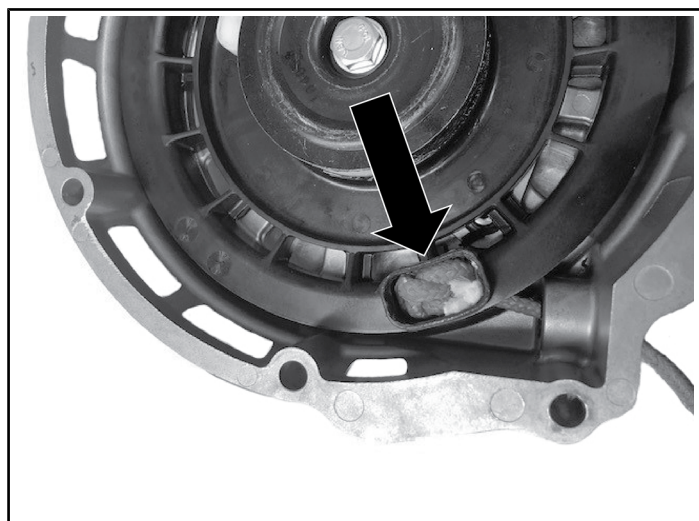
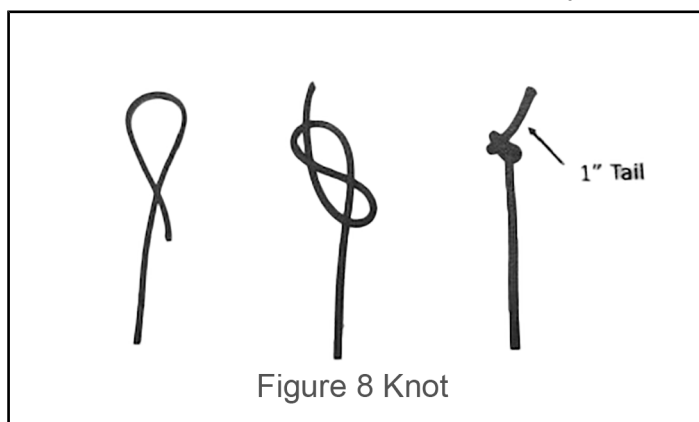

9. Fill recess with silicone. Scrape off excess so it is flush with top of recess.

NOTICE

Make sure silicone is allowed proper set time before proceeding.

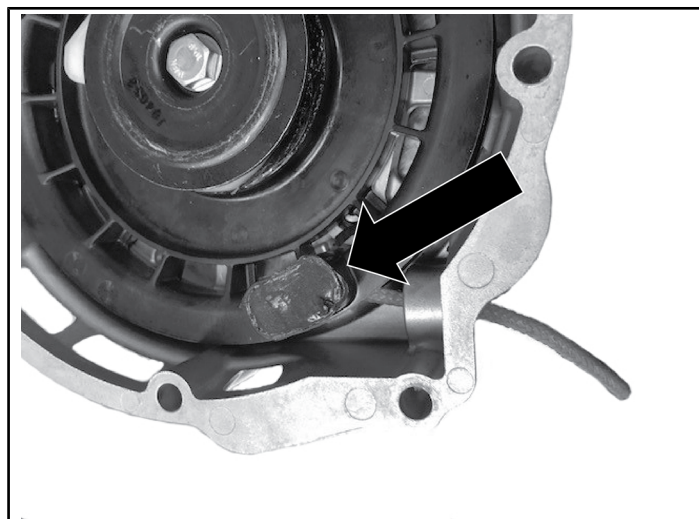

10. Tie an overhand loop knot in the recoil cord.
Remove the screwdriver and guide the cord into the recoil until it bottoms out on the knot.

NOTICE

Leave 24 in. of cord to allow routing through cowl.



Overhand Loop Knot

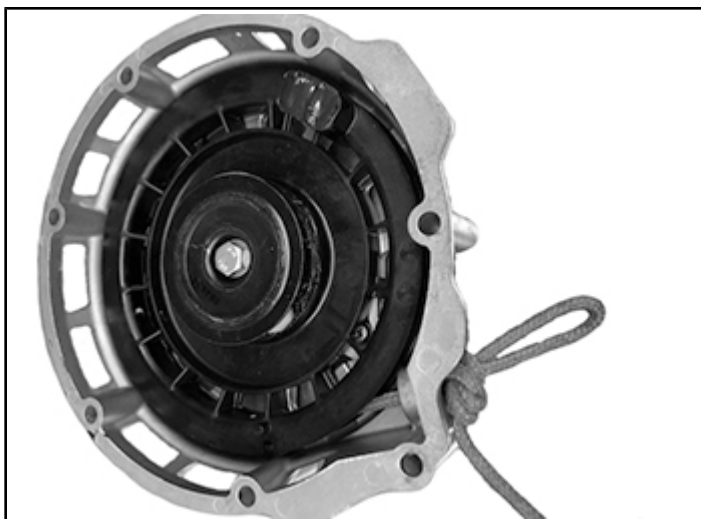

11. Install recoil on snowmobile. Torque to specification in sequence shown in diagram.

TORQUE

Recoil Screws:
106 in-lbs (12 N·m)

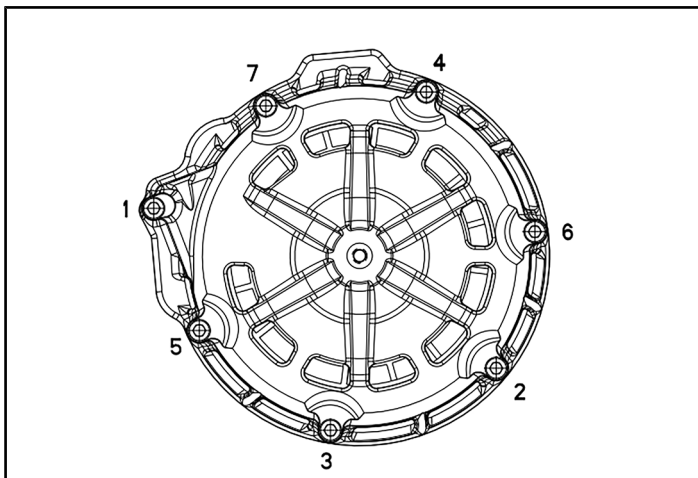
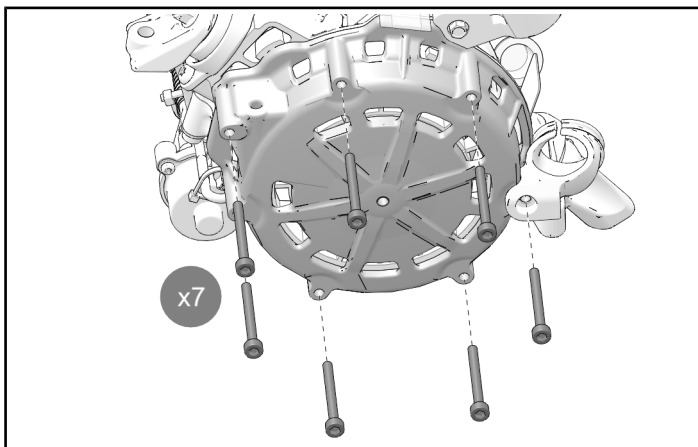
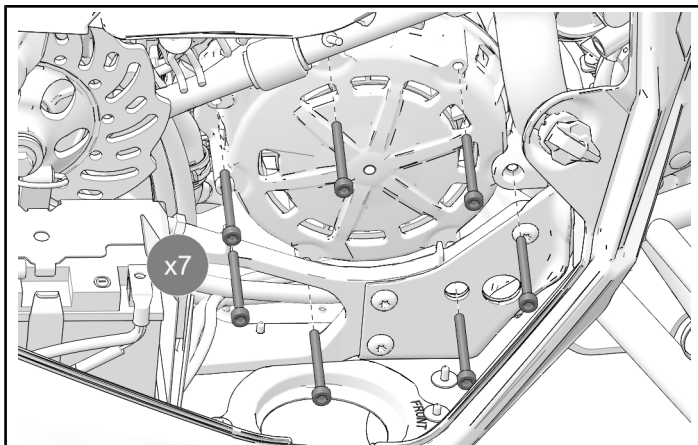

12. Install recoil cord through opening in cowl. Make sure cord goes over pulley.

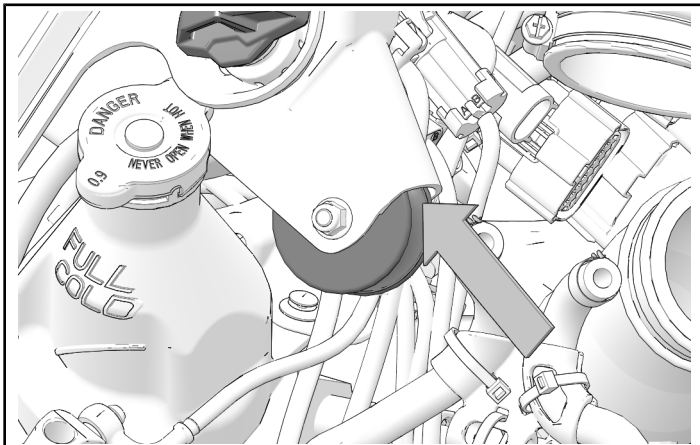

13. Install cord through recoil handle. Tie a figure 8 knot in end of cord and tuck into recess in recoil handle. Trim end of cord if necessary.

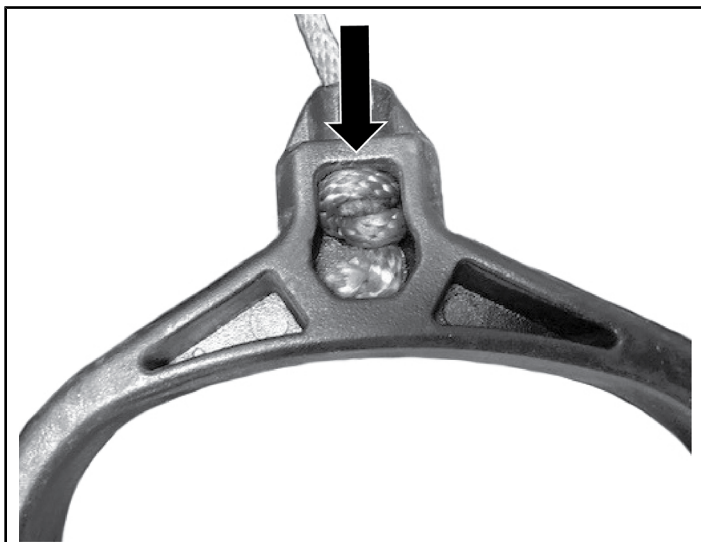
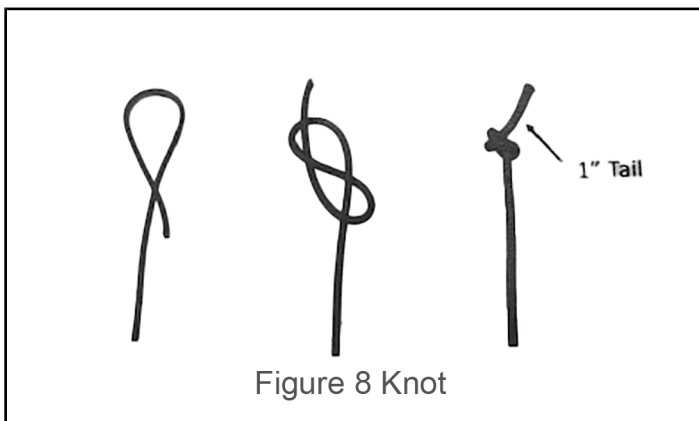

14. Put cover in place on recoil handle.

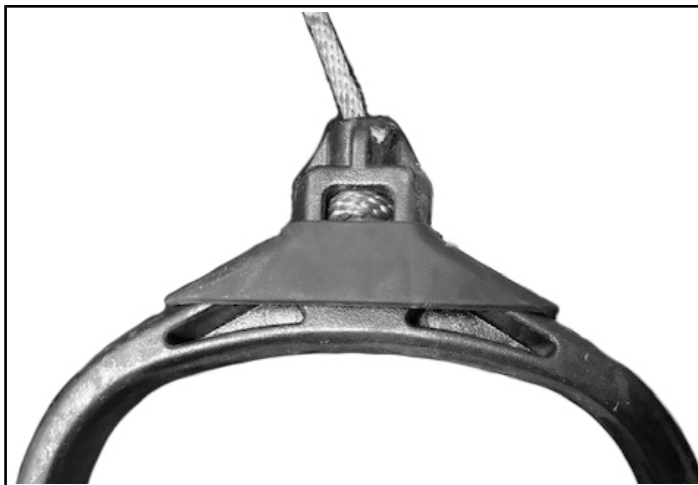

15. Untie knot from cord at recoil opening and guide recoil cord into recoil.

VEHICLE REASSEMBLY

INSTALL EXHAUST SILENCER

1. Put exhaust silencer in position on snowmobile.
2. Install four exhaust springs.

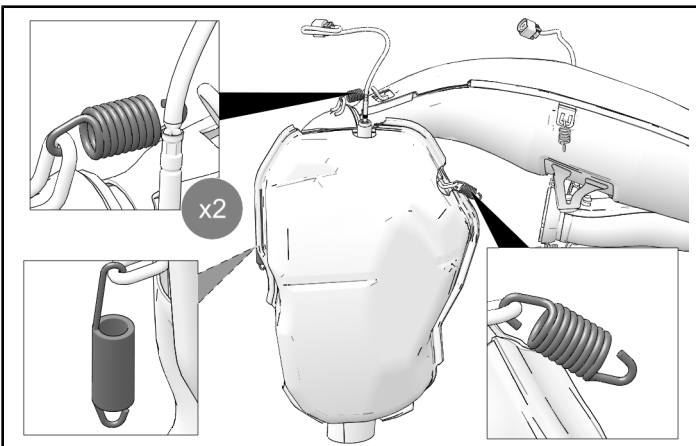
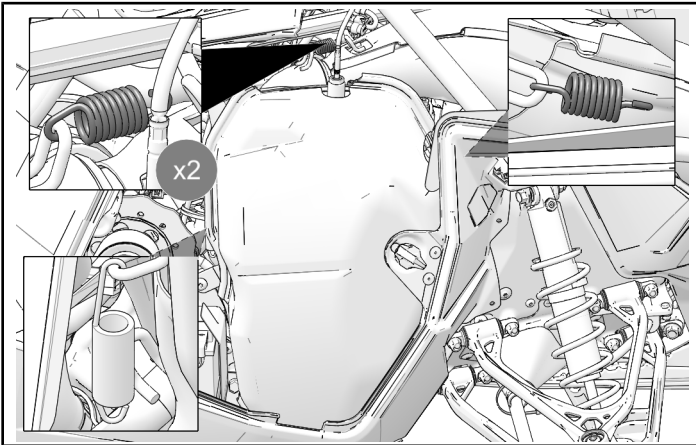

3. Connect exhaust sensor.

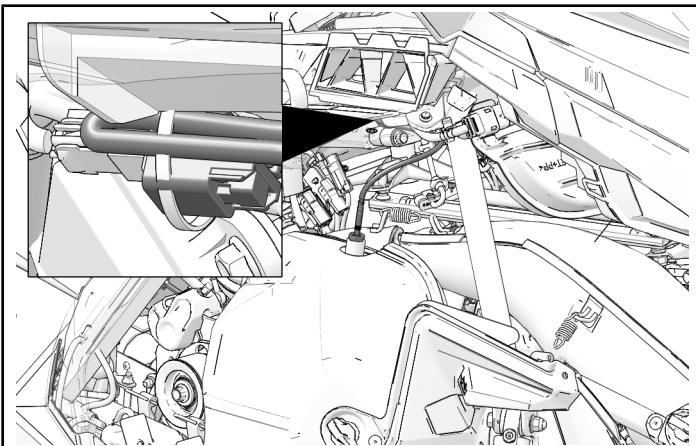

INSTALL BOOST EXHAUST SILENCER

1. Install exhaust silencer on snowmobile.

2. Install v-band clamp.

NOTICE

Install new V-Band Clamp P/N 7082763

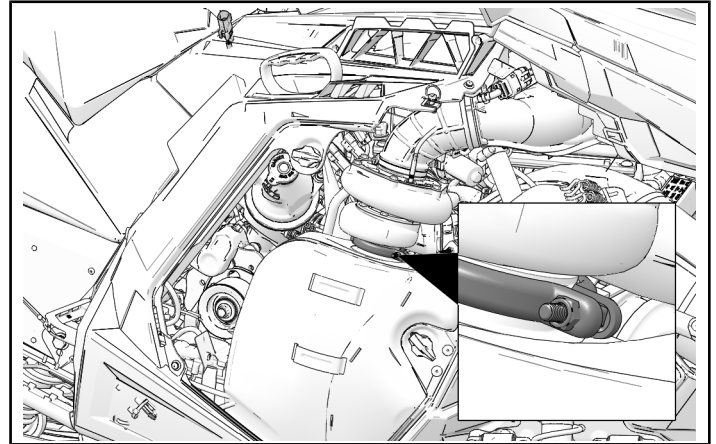

3. Install waste gate tube and two springs.

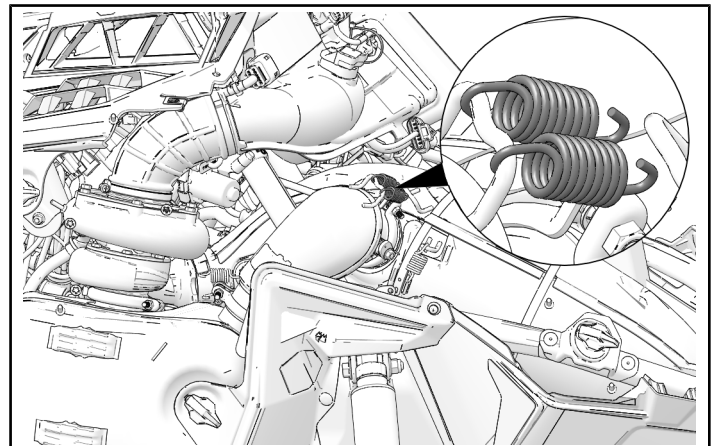

4. Install exhaust spring.

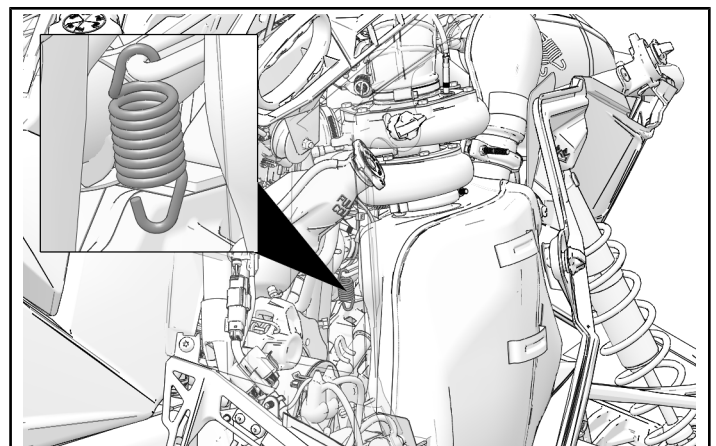

5. Connect exhaust sensor.

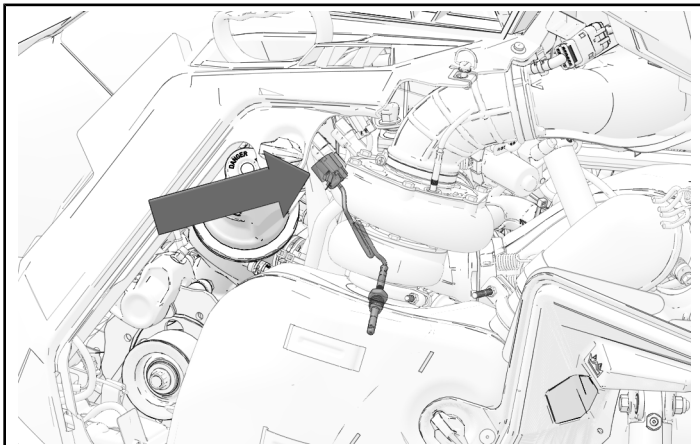

INSTALL RIGHT SIDE PANEL

1. Install side panel on snowmobile. Turn fasteners toward front of snowmobile to lock in place.

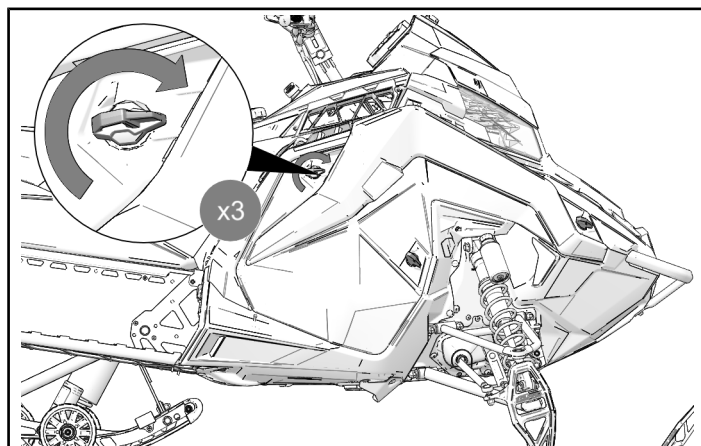

INSTRUCTION FEEDBACK FORM

A feedback form has been created for the installer to provide any comments, questions or concerns about the installation instructions. The form is viewable on mobile devices by scanning the QR code or by clicking [HERE](#) if viewing on a PC.

